

K Type ϕ 75 100 130 150 200 250

Fixed **Plate Type**

BZP (Brilliant Zinc Plating)	CP (Chromium Plating)
Single Bearing	Double Bearing
Single Stopper	Double Stopper



UWK-150

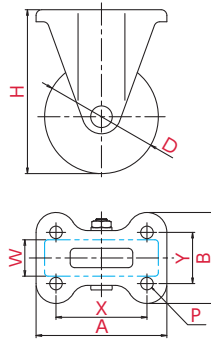

Mounting Method **Plate Type**



Usage

- Flat Trolley
- Hand Trolley
- Server Rack
- Roll Box Pallet
- Towing Trolley
- Office Chair
- Machinery and equipment
- Copying Machine
- Furniture
- Display Rack
- Refrigeration and cold storage showcase
- Others

Use together with **Swivel**

The picture is a typical product image.

Order Example: **UW** | **K** | **-** | **150**
Wheel Type | Bracket Type | Wheel Diameter



Wheel Diameter (D[mm])	Product No.	Wheel Material	Load Capacity [daN (kgf)]	Wheel Width (W[mm])	Mounting Height (H[mm])	Mounting Base (AxB[mm])	Mounting Dimensions (XxY (X'xY') [mm])	Hole Diameter (P[mm])
75	WK-75	Rubber(Including B)	80(81.6)	32	103	95x72	63x40	9.5
	UWK-75	PU(Including B)	120(122.4)					
	GUK-75		100(102.0)					
100	WK-100	Rubber(Including B)	120(122.4)	32	144	115x80	80x45	11
	NRK-100	Rubber(Including B)	100(102.0)					
	WEK-100	Conductive Rubber(Including B)	120(122.4)					
	WOK-100	Oil Resistant Rubber(Including B)						
	WK-100-G	Grey Rubber(Including B)						
	NRK-100-G	Grey Rubber(Including B)	100(102.0)					
	MCBK-100	Monomer Cast Nylon(Including B)	180(183.6)					
	UWK-100	PU(Including B)						
	GUK-100	PU(Including B)						
	UWEK-100	Antistatic PU(Including B)						
PHK-100	Heat Resistant Phenol	100(102.0)						
130	WK-130	Rubber(Including B)	180(183.6)	40	177	137x93	100x56	11
	NRK-130	Rubber(Including B)						
	WEK-130	Conductive Rubber(Including B)						
	WOK-130	Oil Resistant Rubber(Including B)						
	WK-130-G	Grey Rubber(Including B)						
	MCBK-130	Monomer Cast Nylon(Including B)						
	UWK-130	PU(Including B)	250(255.0)	35				
	GUK-130	PU(Including B)	180(183.6)	40				
	UWEK-130	Antistatic PU(Including B)	250(255.0)	35				
	PHK-130	Heat Resistant Phenol	180(183.6)	40				

Wheel Type

Wheel: Steel Tread: Rubber (Including B)	Wheel: Nylon Tread: Rubber (Including B)	Wheel: Aluminum Tread: Rubber (Including B)	Wheel: Steel Tread: Conductive Rubber (Including B)	Wheel: Steel Tread: Oil Resistant Rubber (Including B)	Wheel: Steel Tread: Grey Rubber (Including B)	Wheel: Nylon Tread: Grey Rubber (Including B)	Wheel: Monomer Cast Nylon Tread: Monomer Cast Nylon (Including B)	Wheel: Steel Tread: PU (Including B)